

OSP / OLPS



General Purpose Jacks - Plain Ram, Single Acting, Spring / Load Return

Capacity 5 - 2000 ton / Stroke 50 - 200 mm / Max. Working Pressure 700 bar



OSP Series



OSPS / OLPS Series



Features / Application

- Standard multipurpose application jacks
- Base mounting holes and collar threads are optional
- Spring return mechanism upto 500t, Load return for 600t and above
- Spherical saddle for 500t and above; optional for lower capacities
- Heavy industries, construction, power and process plants, shipbuilding, petrochemical industries

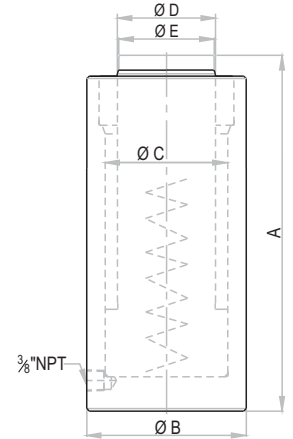

OSP Series - **O** Orione **S** Single acting **S** Spring return **P** Plain ram **5** Capacity - ton **50** Stroke - mm

OSPS Series - **S** Spherical saddle (Tilting angle 5° Max.)

Capacity (ton)	Capacity (kN)	Stroke (mm)	Model with Plain saddle	Model with Spherical saddle	Effective area (cm ²)	Oil cap. (cc)	Closed height (Plain saddle) A (mm)	Closed height (Spherical saddle) A (mm)	Cylinder OD B (mm)	Bore dia. C (mm)	Ram dia. D (mm)	Plain saddle dia. E (mm)	Spherical saddle dia. E (mm)	Wt. (Approx.) (Plain saddle) (kg)	Wt. (Approx.) (Sph. saddle) (kg)
5	56	50	OSP 5-50	-	8.0	40	135	-	45	32	25	25	-	1.3	-
5	56	100	OSP 5-100	-	8.0	80	185	-	45	32	25	25	-	1.8	-
5	56	150	OSP 5-150	-	8.0	121	235	-	45	32	25	25	-	2.3	-
10	111	50	OSP 10-50	OSPS 10-50	15.9	80	135	145	60	45	35	35	35	2.4	2.6
10	111	100	OSP 10-100	OSPS 10-100	15.9	159	185	195	60	45	35	35	35	3.2	3.4
10	111	150	OSP 10-150	OSPS 10-150	15.9	239	235	245	60	45	35	35	35	4	4.2
10	111	200	OSP 10-200	OSPS 10-200	15.9	318	285	295	60	45	35	35	35	4.7	4.9
15	167	50	OSP 15-50	OSPS 15-50	23.8	119	140	155	70	55	45	43	43	4.4	4.6
15	167	100	OSP 15-100	OSPS 15-100	23.8	238	190	205	70	55	45	43	43	5.4	5.6
15	167	150	OSP 15-150	OSPS 15-150	23.8	356	240	255	70	55	45	43	43	6.4	6.6
15	167	200	OSP 15-200	OSPS 15-200	23.8	475	290	305	70	55	45	43	43	7.4	7.6
20	218	50	OSP 20-50	OSPS 20-50	31.2	156	145	160	80	63	50	48	48	4.8	5.1
20	218	100	OSP 20-100	OSPS 20-100	31.2	312	195	210	80	63	50	48	48	6	6.3
20	218	150	OSP 20-150	OSPS 20-150	31.2	468	245	260	80	63	50	48	48	7.4	7.7
20	218	200	OSP 20-200	OSPS 20-200	31.2	623	295	310	80	63	50	48	48	8.6	8.9
25	270	50	OSP 25-50	OSPS 25-50	38.5	192	155	170	90	70	55	53	48	6.7	7
25	270	100	OSP 25-100	OSPS 25-100	38.5	385	205	220	90	70	55	53	48	8.4	8.7
25	270	150	OSP 25-150	OSPS 25-150	38.5	577	255	270	90	70	55	53	48	10	10.3
25	270	200	OSP 25-200	OSPS 25-200	38.5	770	305	320	90	70	55	53	48	11.8	12.1
30	309	50	OSP 30-50	OSPS 30-50	44.2	221	160	175	100	75	60	58	55	9	9.4
30	309	100	OSP 30-100	OSPS 30-100	44.2	442	210	225	100	75	60	58	55	11.5	11.9
30	309	150	OSP 30-150	OSPS 30-150	44.2	663	260	275	100	75	60	58	55	13.5	13.9
30	309	200	OSP 30-200	OSPS 30-200	44.2	884	310	325	100	75	60	58	55	15.5	15.9

- Higher capacity and customized solutions on request. ■ Specifications are subject to change due to continual improvement.
- Capacity and Stroke specified are maximum safe limits. As safe practice, use at 80% of rating.

CUSTOMISED SOLUTIONS



General Purpose Jacks - Plain Ram, Single Acting, Spring / Load Return

Capacity 5 - 2000 ton / Stroke 50 - 200 mm / Max. Working Pressure 700 bar

OSP Series - **O** Orione **S** Single acting Spring return **P** Plain ram **50** Capacity - ton **50** Stroke - mm

OSPS Series - **S** Spherical saddle (Tilting angle 5° Max.)

Capacity (ton)	Capacity (kN)	Stroke (mm)	Model with Plain saddle	Model with Spherical saddle	Effective area (cm ²)	Oil cap. (cc)	Closed height (Plain saddle) A (mm)	Closed height (Spherical saddle) A (mm)	Cylinder OD B (mm)	Bore dia. C (mm)	Ram dia. D (mm)	Plain saddle dia. E (mm)	Spherical saddle dia. E (mm)	Wt. (Approx.) (Plain saddle) (kg)	Wt. (Approx.) (Sph. saddle) (kg)
50	550	50	OSP 50-50	OSPS 50-50	78.5	393	175	190	130	100	80	78	74	15.5	16
50	550	100	OSP 50-100	OSPS 50-100	78.5	785	225	240	130	100	80	78	74	19	19.5
50	550	150	OSP 50-150	OSPS 50-150	78.5	1178	275	290	130	100	80	78	74	22.5	23
50	550	200	OSP 50-200	OSPS 50-200	78.5	1571	325	340	130	100	80	78	74	26.5	27
75	792	50	OSP 75-50	OSPS 75-50	113.1	565	180	205	155	120	95	93	88	22	22.9
75	792	100	OSP 75-100	OSPS 75-100	113.1	1131	230	255	155	120	95	93	88	27	27.9
75	792	150	OSP 75-150	OSPS 75-150	113.1	1696	280	305	155	120	95	93	88	33	33.9
75	792	200	OSP 75-200	OSPS 75-200	113.1	2262	330	355	155	120	95	93	88	38	38.9
100	1077	50	OSP 100-50	OSPS 100-50	153.9	770	185	205	180	140	110	108	100	30	31
100	1077	100	OSP 100-100	OSPS 100-100	153.9	1539	235	255	180	140	110	108	100	37.5	38.5
100	1077	150	OSP 100-150	OSPS 100-150	153.9	2309	285	305	180	140	110	108	100	44.5	45.5
100	1077	200	OSP 100-200	OSPS 100-200	153.9	3079	335	355	180	140	110	108	100	52	53
150	1589	50	OSP 150-50	OSPS 150-50	227.0	1135	200	225	220	170	140	138	130	54	56
150	1589	100	OSP 150-100	OSPS 150-100	227.0	2270	250	275	220	170	140	138	130	65	67
150	1589	150	OSP 150-150	OSPS 150-150	227.0	3405	300	325	220	170	140	138	130	76	78
200	2199	50	OSP 200-50	OSPS 200-50	314.2	1571	215	240	255	200	160	158	150	71	74.5
200	2199	100	OSP 200-100	OSPS 200-100	314.2	3142	265	290	255	200	160	158	150	86.5	90
200	2199	150	OSP 200-150	OSPS 200-150	314.2	4712	315	340	255	200	160	158	150	102	105.5
250	2661	100	OSP 250-100	OSPS 250-100	380.1	3801	270	305	280	220	180	177	165	109	114
250	2661	150	OSP 250-150	OSPS 250-150	380.1	5702	320	355	280	220	180	177	165	126	131
250	2661	200	OSP 250-200	OSPS 250-200	380.1	7603	370	405	280	220	180	177	165	143	148
300	3167	100	OSP 300-100	OSPS 300-100	452.4	4524	285	320	310	240	200	196	180	141	148
300	3167	150	OSP 300-150	OSPS 300-150	452.4	6786	335	370	310	240	200	196	180	164	171
300	3167	200	OSP 300-200	OSPS 300-200	452.4	9048	385	420	310	240	200	196	180	187	194
400	4008	100	OSP 400-100	OSPS 400-100	572.6	5726	315	355	350	270	220	216	212	190	201
400	4008	150	OSP 400-150	OSPS 400-150	572.6	8588	365	405	350	270	220	216	212	217	228
400	4008	200	OSP 400-200	OSPS 400-200	572.6	11451	415	455	350	270	220	216	212	243	254
500	4948	100	-	OSPS 500-100	706.9	7069	-	365	400	300	250	-	230	-	270
500	4948	150	-	OSPS 500-150	706.9	10603	-	415	400	300	250	-	230	-	306
500	4948	200	-	OSPS 500-200	706.9	14137	-	465	400	300	250	-	230	-	343

OLPS Series - **O** Orione **L** Single acting Load return **P** Plain ram **S** Spherical saddle (Tilting angle 5° Max.) **600** Capacity - ton **100** Stroke - mm

Capacity (ton)	Capacity (kN)	Stroke (mm)	Model	Effective area (cm ²)	Oil cap. (cc)	Closed height A (mm)	Cylinder OD B (mm)	Bore dia. C (mm)	Ram dia. D (mm)	Saddle dia. E (mm)	Wt. (Approx.) (kg)
600	5987	100	OLPS 600-100	855.3	8553	390	430	330	275	260	357
600	5987	150	OLPS 600-150	855.3	12829	440	430	330	275	260	404
600	5987	200	OLPS 600-200	855.3	17106	490	430	330	275	260	450
800	7939	100	OLPS 800-100	1134.1	11341	425	505	380	310	290	525
800	7939	150	OLPS 800-150	1134.1	17012	475	505	380	310	290	590
800	7939	200	OLPS 800-200	1134.1	22682	525	505	380	310	290	654
1000	9930	100	OLPS 1000-100	1418.6	14186	460	560	425	350	330	721
1000	9930	150	OLPS 1000-150	1418.6	21279	510	560	425	350	330	800
1000	9930	200	OLPS 1000-200	1418.6	28373	560	560	425	350	330	879
1500	15154	100	OLPS 1500-100	2164.8	21648	545	705	525	450	400	1352
1500	15154	150	OLPS 1500-150	2164.8	32472	595	705	525	450	400	1482
1500	15154	200	OLPS 1500-200	2164.8	43296	645	705	525	450	400	1612
2000	20458	100	OLPS 2000-100	2922.5	29225	615	810	610	525	495	2023
2000	20458	150	OLPS 2000-150	2922.5	43837	665	810	610	525	495	2195
2000	20458	200	OLPS 2000-200	2922.5	58450	715	810	610	525	495	2367

■ Higher capacity and customized solutions on request. ■ Specifications are subject to change due to continual improvement.

■ Capacity and Stroke specified are maximum safe limits. As safe practice, use at 80% of rating.

CUSTOMISED SOLUTIONS

